

## HOW IT WORKS

- 1 The camera monitors your animals. The signal is transmitted through the cable (9-18m) to the outdoor antenna.
- 2 The signal is sent wirelessly to the office/home.
- 3 The receiver receives the signal through its outdoor antenna connected with cable (9-18m).
- 4 By connecting the receiver to your TV you can see the camera picture there as well!
- 5 By connecting the receiver to your internet router you can see your animals/barn/buildings/farm wherever you go, using any smartphone, tablet or computer connected to the internet.

## INCLUDED IN THE BOX

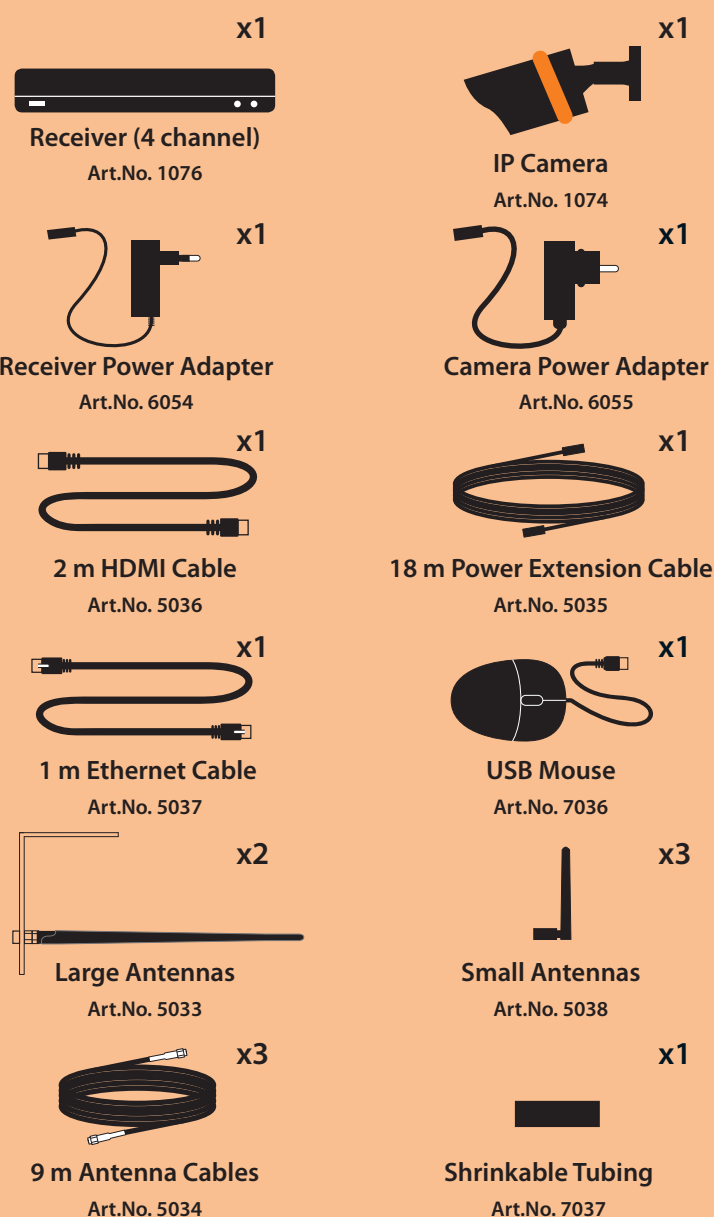

## INSTALLATION

- A** Mount the large outdoor antennas vertically as illustrated below. Place them at the same height and avoid any nearby metal objects.  
**NOTE:** Only use the large antenna with minimum 9m antenna cable.

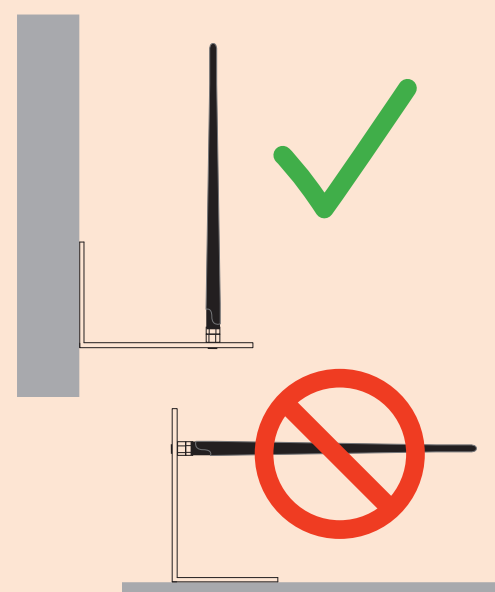

- B** Connect the antennas to camera and receiver using the 9 m antenna cables. Connect the camera to power. Water-proof the camera power connector using the shrinkable tube.

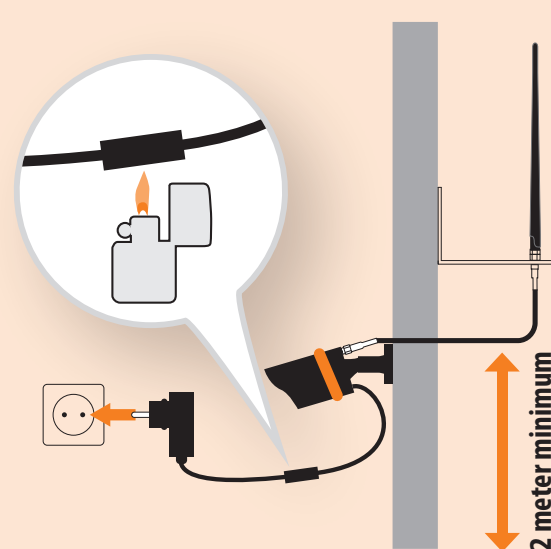

- C** Connect the receiver to power. The system will setup automatically

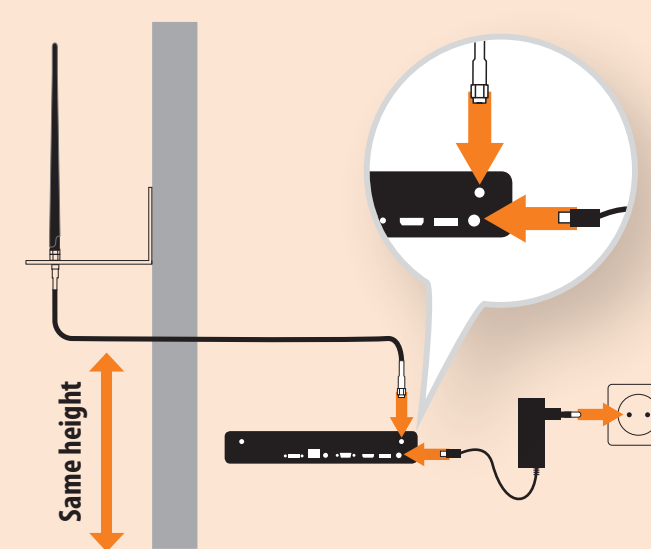

## TIP!

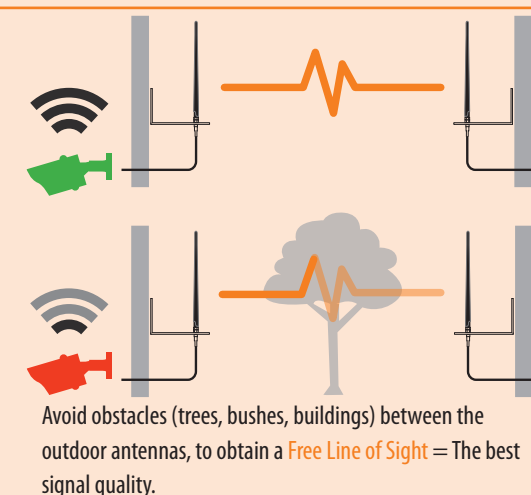
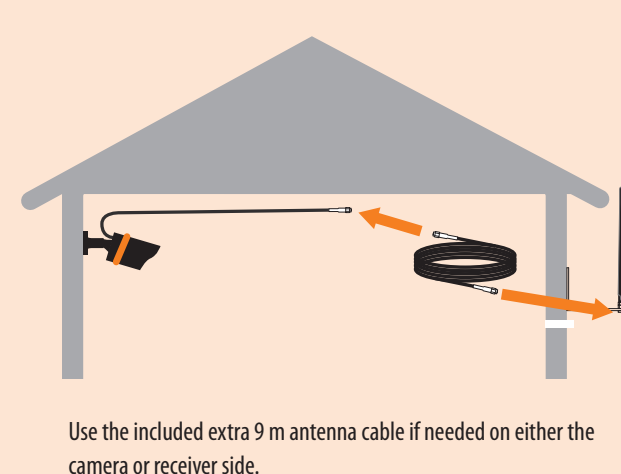
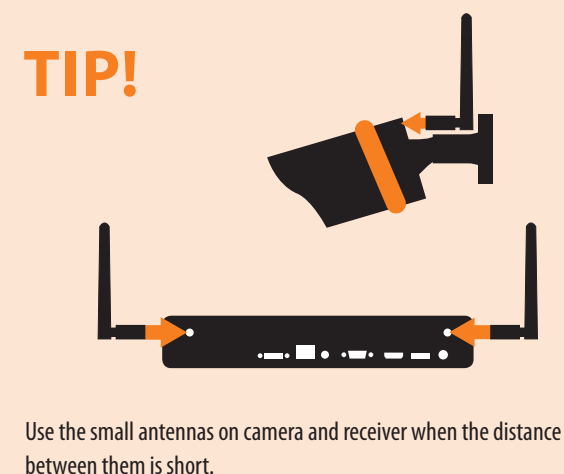



## TV installation? START HERE!

- 1** Connect the tv and mouse to your receiver.

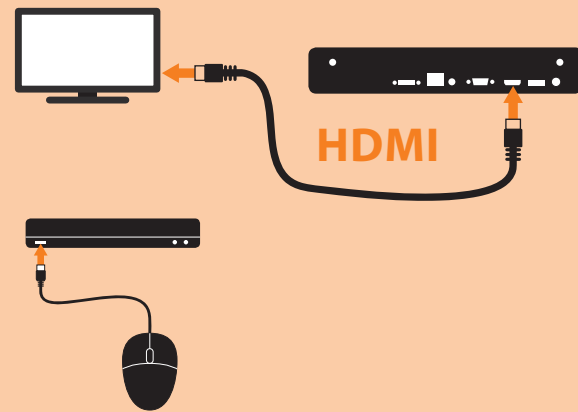

- 2** a) Choose the HDMI-channel on your tv  
b) Choose your password (minimum 6 letters). **NOTE!** You must remember the password to log in if you do not choose to tick the checkbox  
c) Click on the button to save and continue

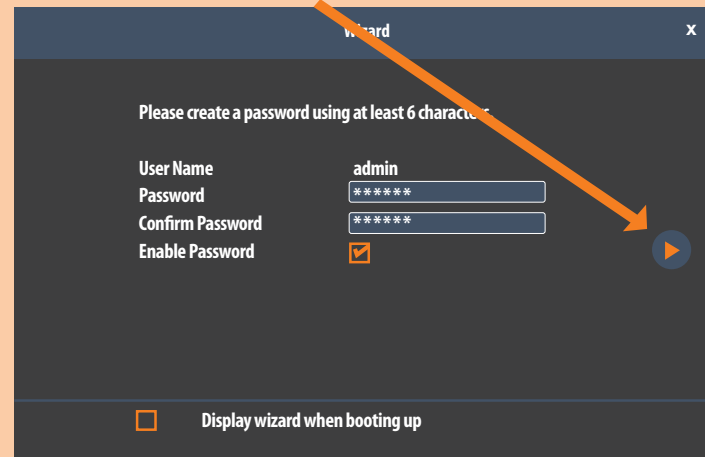

**NOTE! You can write down your password in the field below**

.....

- 3** a) Choose your language  
b) Click on the button to save and on to finish\*

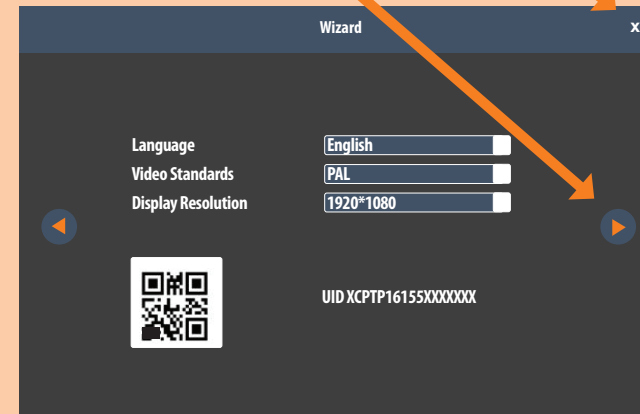

\*= this is enough to get going with your FarmCam HD. You can do more settings at a later stage.

- 4** a) **DOUBLE-CLICK** on the image to get it in full screen  
b) **RIGHT-CLICK** to see the options:



c) **YOU'RE DONE** with the quick setup of FarmCam HD on your tv!

If you want to see the picture on your mobile or pc, continue to step 5.



## SmartPhone installation only? START HERE!

- 5** Connect the receiver to your broadband router using the ethernet cable.

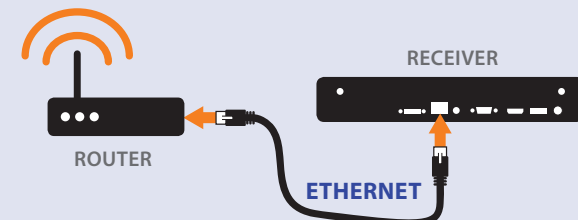

1 m cable is included. If you need a longer cable you can easily find it in most stores carrying electronics.

- 6** Make sure your mobile is using the same Wi-Fi/net-work as your receiver

- 7** a) Download and install the FarmCam HD app from Appstore or Google play.



- b) Open the app:  
c) Allow notifications (iPhone only)



- 8** If you have you not done the installation on tv, skip step 9-10 and proceed to step 11.

- 9** a) This will show up if your Smartphone is connected to the same Wifi network as the Receiver. If so, go to step B and C.

If it doesn't show up, click on the button "Add new device" and then scan the QR code on the Receiver. Then jump to step 10.

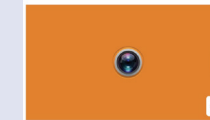

- b) Press:

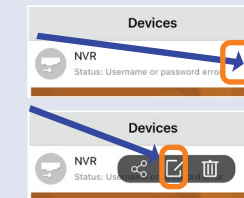

- c) Then press:

- 10** a) Choose the same password as on the tv

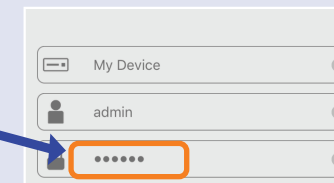

- b) Press save



- 11** Press to see video

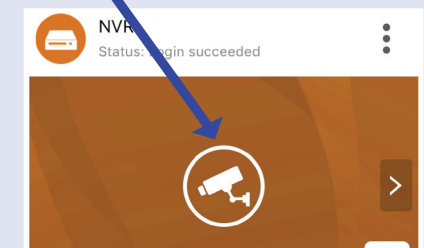

- 12** 1 MIN REGISTRATION = 1 YEAR EXTRA WARRANTY  
Register your farmCam HD and get 3 years warranty.

Go to: [www.luda.farm/warranty-register](http://www.luda.farm/warranty-register)



To download pc-software and read about how to get going with FarmCam HD on your computer,

go to:  
[www.luda.farm/farmcamHD](http://www.luda.farm/farmcamHD)



## HOW IT WORKS

### How the app works

1. Access to devices
2. Live view
3. Play/stop
4. Sound on/off
5. Take snapshot (to mobile)
6. Record video (to mobile)
7. Amount of camera views
8. Video quality
9. Full screen
10. Playback mode

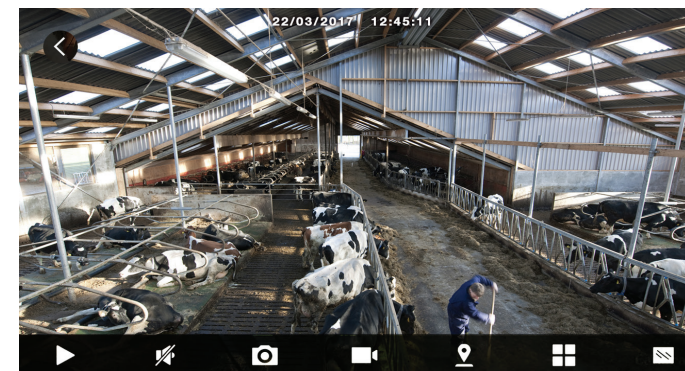
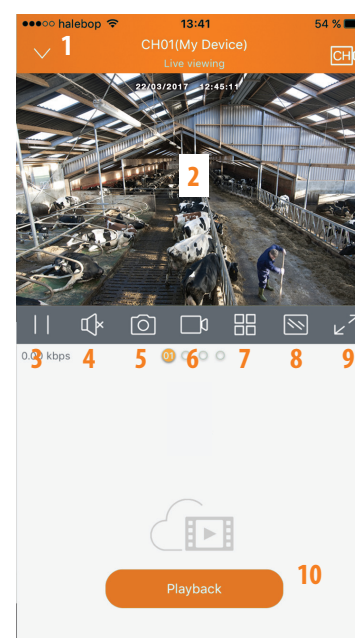

Play/stop  
Sound on/off  
Take snapshot  
Record video  
Not used  
Multiple screens  
Video quality

### Technical Specifications for Art.No. 1073:

**2.4GHz Wireless Camera**  
Frequency Bands:  
802.11b/g/n(20MHz): 2412-2472MHz  
802.11n(40MHz): 2422-2462 MHz  
Maximum radio frequency effect: up to 20 dBm  
Modulation Mode: CCK70FDM7DBPSK7DAPSK  
Wireless Range: 1250 m  
Resolution: 1920 x1080p  
Video Frame Rate: 15fps @ 1080p  
Angle of View: 90°  
IR night range: 30 Meters  
Image Sensor: 1/3" 1080P CMOS  
Microphone: Embedded mic  
Power Supply adapter: 100-240V  
Power to camera: DC12V -1A  
Operating temperature: -20 °C~+55 °C  
IP classification: IP66  
Dimensions: Ø70 x 190mm

**2.4GHz Wireless Receiver NVR**  
Frequency Bands:  
802.11b/g/n(20MHz):2412-2472MHz  
802.11n(40MHz):2422-2462 MHz  
Maximum radio frequency effect: up to 20 dBm  
Modulation Mode: CCK70FDM7DBPSK7DAPSK  
Resolution: 1920 x1080p  
Maximum Cameras: 4  
Hard Drive included: 1 TB  
Video output: HDMI & VGA  
Audio output: RCA  
Network Interface: RJ 45 Ethernet  
Supported systems: Android, Iphone, MAC & PC  
Power Supply adapter: 100-240V  
Power to receiver: DC12V - 2A  
Operating temperature: -10°C~+55°C



Luda.Farm AB,  
Kroksläts Fabriker 30,  
431 37 Mölndal/Sweden